

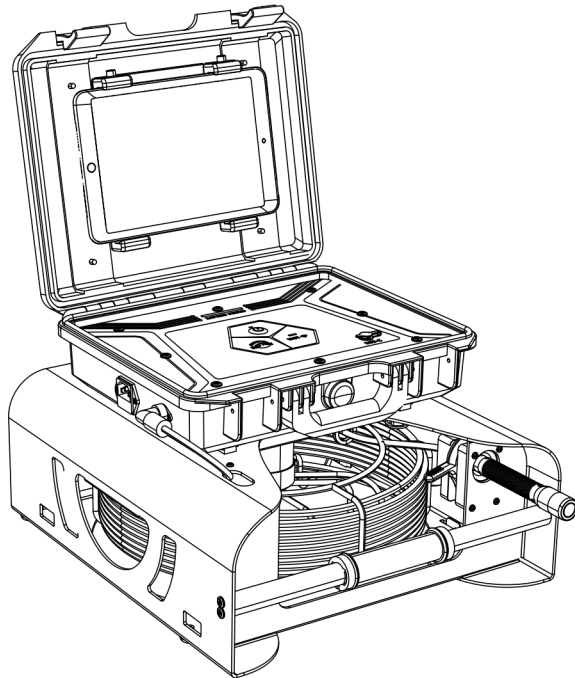

# SPARTAN TOOL

FOR TOUGH CUSTOMERS

SINCE 1943



## PRODUCT MANUAL TRAVELER LITE-2

► Read this manual carefully before operating this system



# WARNING

1. Never use this device in an environment with explosive materials such as GAS, OIL, ETC.
2. Avoid using the device in extremely cold, hot or humid environments; otherwise it may damage the device. Do not drop or press hard on the device.
3. Avoid using the parts / components from other manufacturers to this system, which may damage the equipment due to the incompatibility.
4. Warranty invalid if the device is disassembled by users or if there are any physical damages.
5. The system's PUSH CABLE that is made of Fiberglass is very rigid. It CAN NOT be bent sharply or pushed too hard; otherwise it will be broken.

# CONTENTS

- Product List ..... 1
- Specifications ..... 2
- 23mm Camera Head ..... 3
- Parts & Accessories ..... 4
- Traveler Lite-2 ..... 4
- Control Box (64070081) ..... 5
- Rail assembly, control box (64070034) ..... 5
- Control Box (inside) ..... 6
- Tablet holder, TL-2 (64070033) ..... 7
- Battery holder, TL-2 (64070017) ..... 7
- Control Panel Assembly with PCBA (64070082) ..... 8
- TL-2 (64070012) ..... 9
- Cable Reel ..... 10
- Accessories TL-2 ..... 11

# Product List

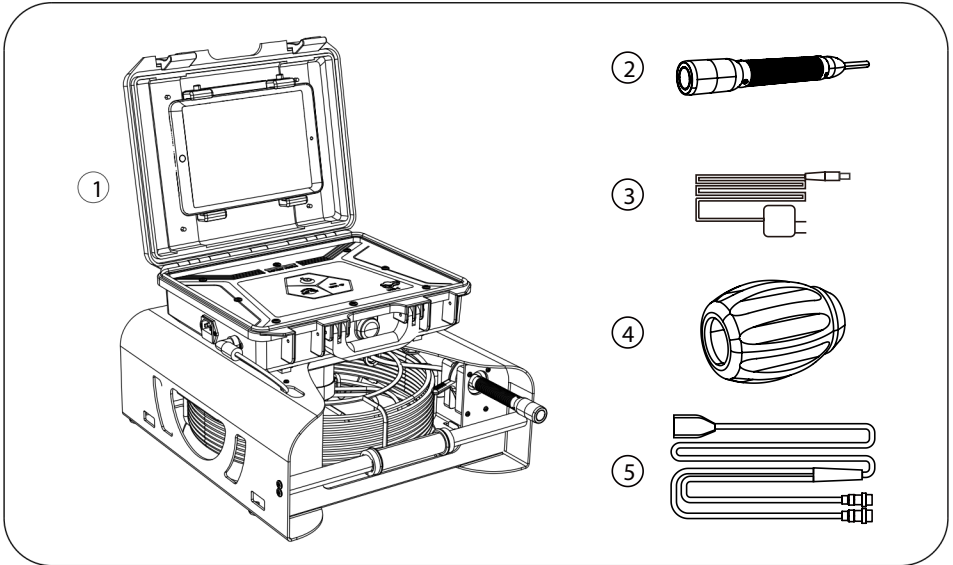

- (1) Traveler Lite-2
- (2) Camera head, 23 mm, HD, Traveler Lite
- (3) AC power cord
- (4) Centering guide
- (5) Testing cord

# Specifications

Item	Description
Battery (In the case)	YBG 18650-2S3P, 10.5Ah, 7.4V, 77.7Wh
Battery Life	up to 8 hours
Cable Length	40M(130FT)
Camera Light	Built-in White LED lights (9 pcs)
Camera Angle-of-View	120°
Camera Image	1920 (H) x 1080V
System Operating Temperature	-70° F to +130° F

Application:

1. Pipe inspection
2. Waste water system inspection
3. Cable ducting system inspection
4. Ventilation system inspection

**WARNING:**  
Draining the battery completely will reduce the battery capacity.

# 23mm Camera Head (with self-leveling)

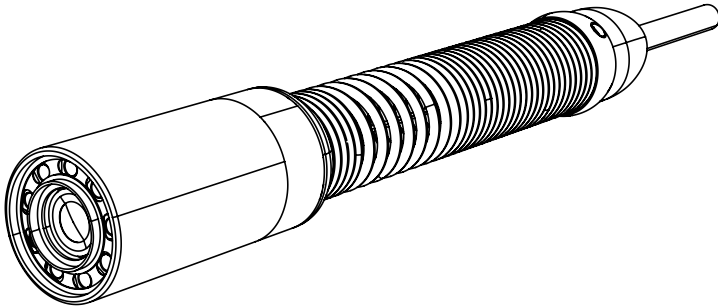

## Working environment:

Temperature: -70° F ~+130° F

## Technical specifications:

(1) Power input: DC 9~13V, 13W ( max)

(2) Camera module:

- 1) Image sensor: 1/3 inch CMOS
- 2) Effective pixel array: 1920(H)x1080(V)
- 3) White Balance: Automatic
- 4) Gain Control: Automatic
- 5) Signal-to-noise ratio: > 45dB(AOC on)
- 6) Video output: 1.0Vp-p/75R
- 7) Input voltage: DC3.3-5V
- 8) Current consumption: 110mA
- 9) Frame rate: 30FPS/25FPS

(3) Light Source:

- 1) LED quantity: 9 pcs
- 2) LED brightness: 200LM
- 3) LED current: 0~200mA
- 4) Light angle: 120°

External interface:

CAM: Pins 1 to 4 are connected to  
VIDEO, GND, +12V, LED

## WARNING:

Continuously using the camera head with the maximum LED intensity may reduce LED life.

# Parts & Accessories

## Traveler Lite-2

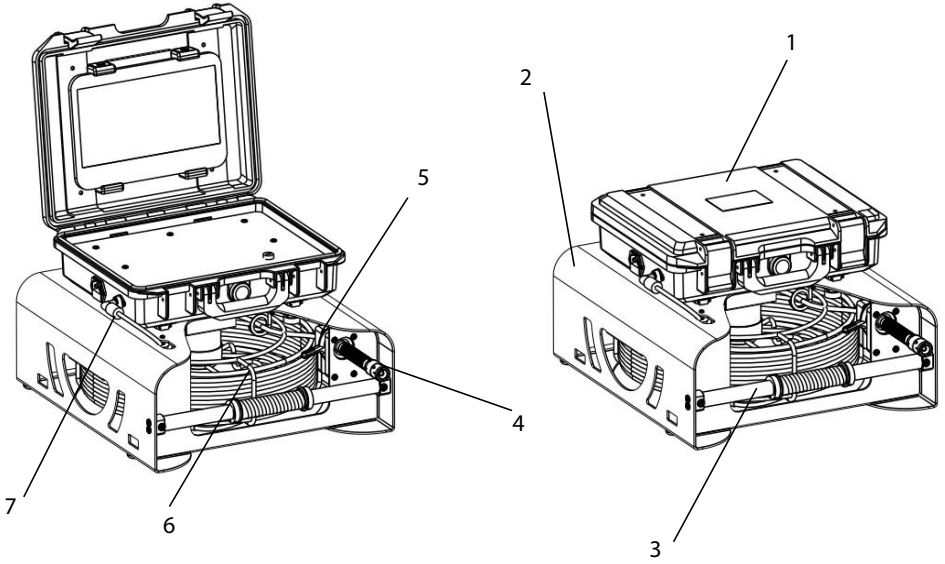

Item	Part Number	Description	Qty.
1	64070081	Control box, Traveler Gen 2	1
2	64070099	Metal cover, TL-2	1
3	64070101	Handle, TL-2	1
4	64070048 / 64070006	Camera head, 23mm, TL / Camera head, 23mm with Self-leving, TL-2	1
5	64070102	Camera holder, TL-2	1
6	64070084	Cable reel with cable and slip ring, TL-2	1
7	64070088	Cable, control box to reel, TL-2	1

# Control Box(64070081)

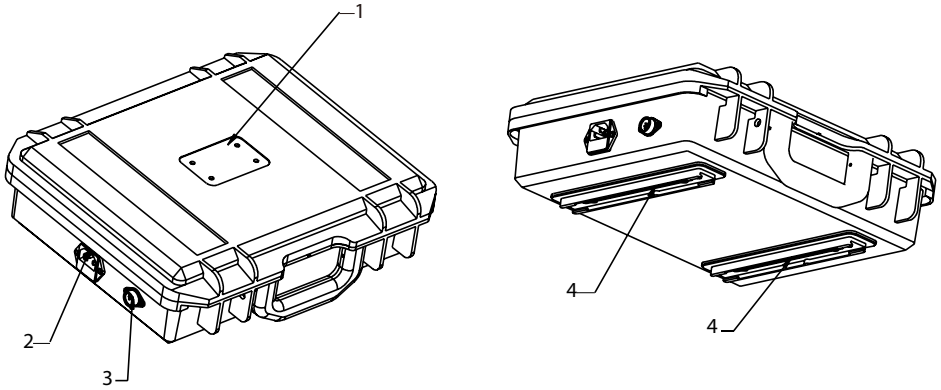

Item	Part Number	Description	Qty.
1		Decal, control box, TL-2	1
2	64070020	AC receptacle, TL-2	1
3	64070029	Aviation connector, control box, TL-2	1
4	64070034	Rail assembly, control box, TL-2	2

# Rail assembly, control box(64070034)

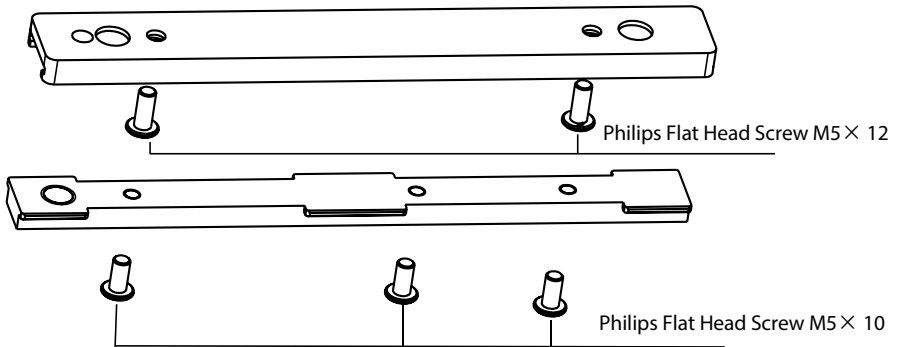

# Control Box(inside)

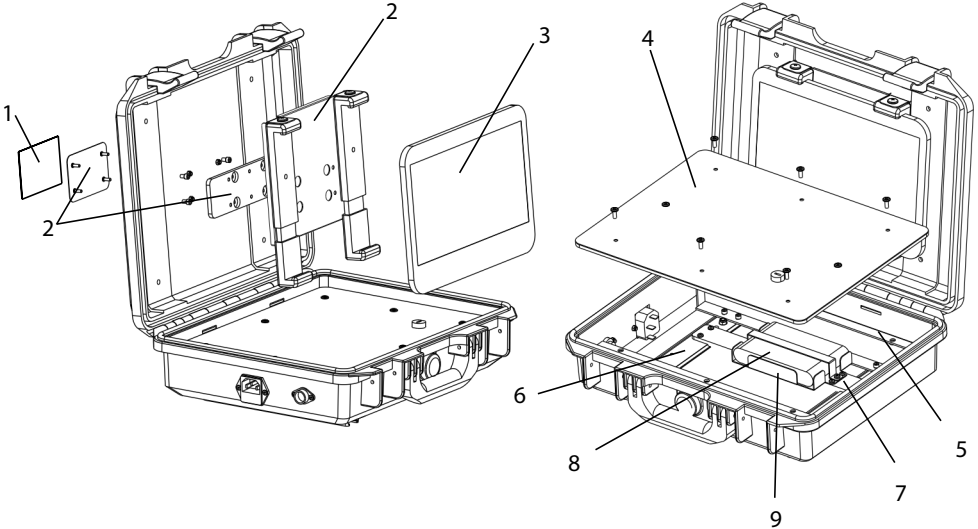

Item	Part Number	Description	Qty.
1	64070090	Decal, control box, TL-2	1
2	64070033	Tablet holder, TL-2	1
3	64070032	Spartan iPad with tough case	1
4	64070082	Control Box panel assembly with PCBA, TL-2	1
5	64070016	Control Box panel stand, TL-2	2
6	64070018	Vertical bar, control box, TL-2	2
7	64070019	Horizontal bar, control box, TL-2	1
8	64050035	Battery, Traveler, 6-cell	1
9	64070017	Battery holder, TL-2	1

# Tablet holder, TL-2(64070033)

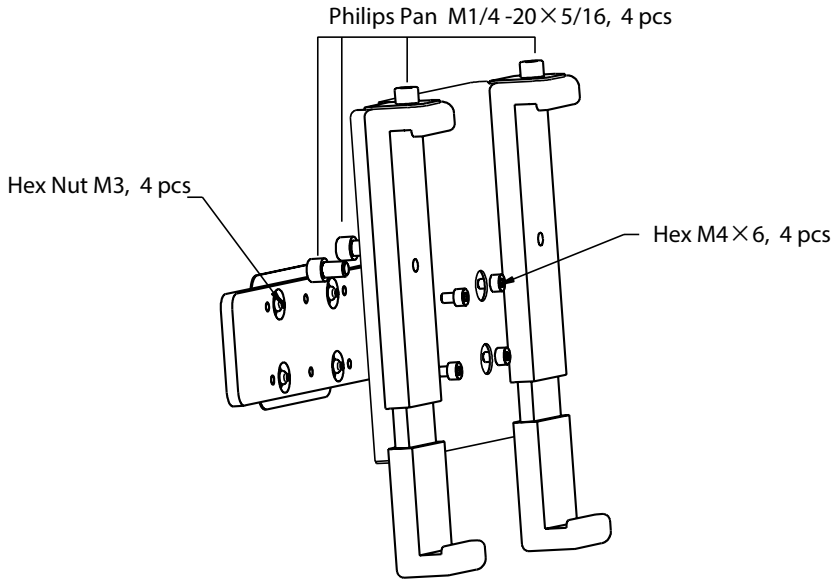

# Battery holder, TL-2(64070017)

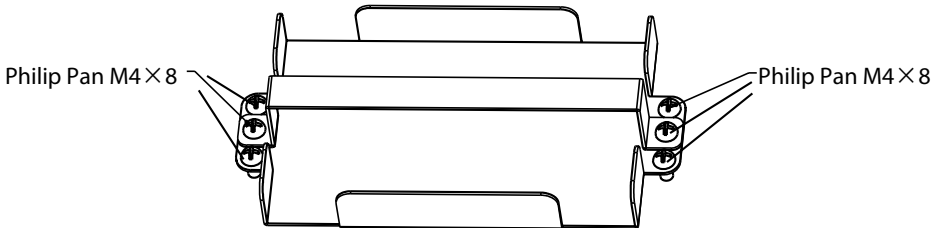

# Control Panel Assembly with PCBA (64070082)

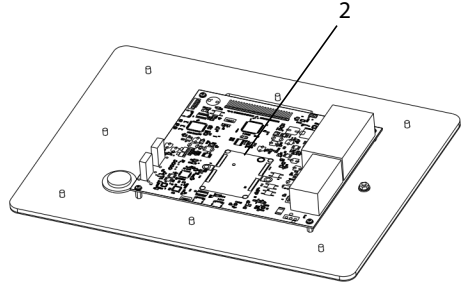
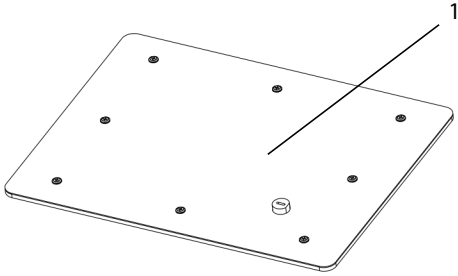

Item	Part Number	Description	Qty.
1	64070103	Control panel assembly, Traveler Gen 2	1
2	64070098	Interface board, Traveler Gen 2	1

# TL-2(64070012)

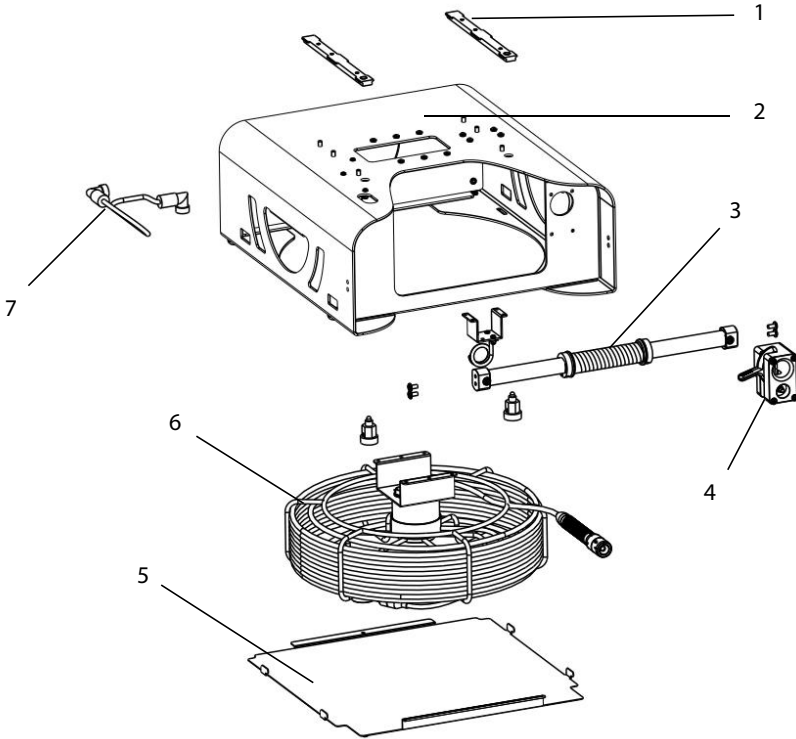

Item	Part Number	Description	Qty.
1	64070034	Rail assembly, control box, TL-2	2
2	64070099	Metal cover,upper body,TL-2	1
3	64070101	Handle,TL-2	1
4	64070102	Camera holder,TL-2	1
5	64070100	Metal cover,lower body,TL-2	1
6	64070084	Cable reel with cable and slip ring,TL-2	1
7	64070088	Video cord, TL2	1

# Cable Reel

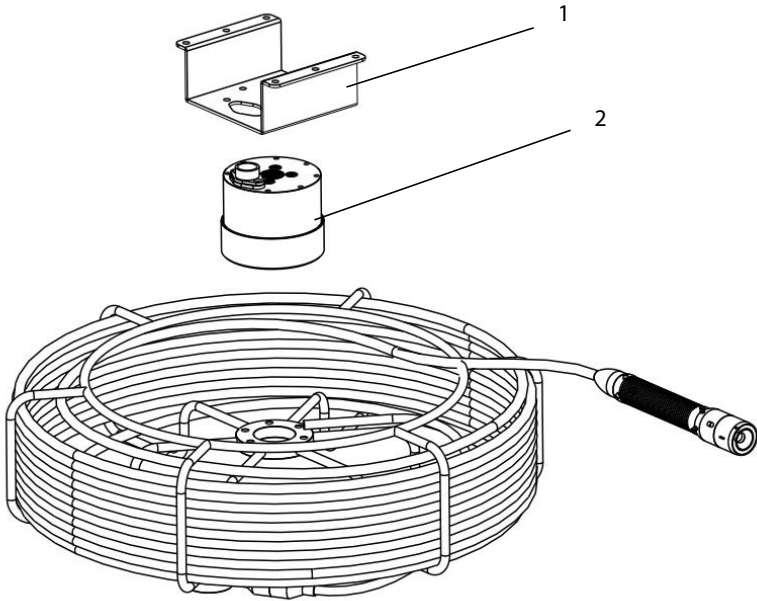

Item	Part Number	Description	Qty.
1	64070086	Slip ring Bracket,TL-2	1
2	64070085	Slip Ring,TL-2	1

# Accessories

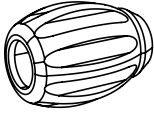

1

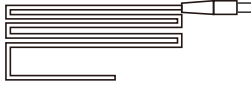

2

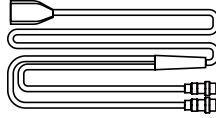

3

Item	Part Number	Description	Qty.
1	64070035	Centering guide, TL-2	1
2	64020010	AC power cord, 118" - Red	1
3	64070087	Test cord, TL-2	1



**SPARTAN TOOL**

FOR TOUGH CUSTOMERS

— SINCE 1943 —

**CONTACT US**  
**Spartan Tool LLC**  
1618 Terminal Road  
Niles, MI 49120  
800.435.3866  
**SpartanTool.com**