

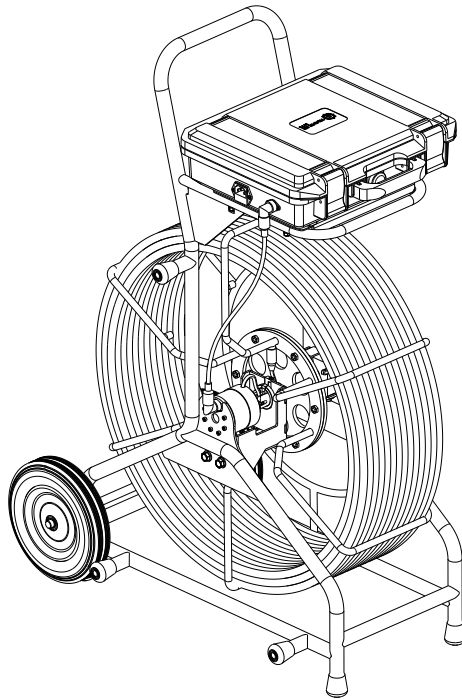

# SPARTAN TOOL

FOR TOUGH CUSTOMERS

— SINCE 1943 —



## PRODUCT MANUAL

---

► Read this manual carefully before operating this system

 **WARNING**

1. Do not operate the device in environments containing flammable or explosive materials (e.g., gas, oil, solvents).
2. Avoid using the device in extremely cold, hot or humid environments; otherwise it may damage the device. Do not drop or press hard on the device.
3. Do not use parts or components from other manufacturers, as they may be incompatible and could damage the system.
4. Warranty invalid if the device is disassembled by users or if there are any physical damages.
5. The fiberglass push cable is very rigid. Do not bend it sharply or apply excessive force, as this may cause breakage.

# CONTENTS

- Traveler Generation 2 ..... 1
- Control Box (64070081) ..... 2
- Rail Assembly, Control Box (64070034) ..... 2
- Control Box (inside) ..... 3
- Tablet Holder, TL2 (64070033) ..... 4
- Battery Holder, TL2 (64070017)..... 4
- Control Panel Assembly With PC BA (64070082) ..... 5
- TRAVELER XL HD..... 6
- Product List..... 7
- Specifications ..... 8
- 40mm Camera Head (With Self-leveling) ..... 9
- Parts & Accessories (TRAVELER XL HD) ..... 10
- Body Frame Assembly, Traveler XL HD..... 11
- Cable Reel W/ Cable (64070075), Traveler XL HD..... 12

# Traveler Generation 2

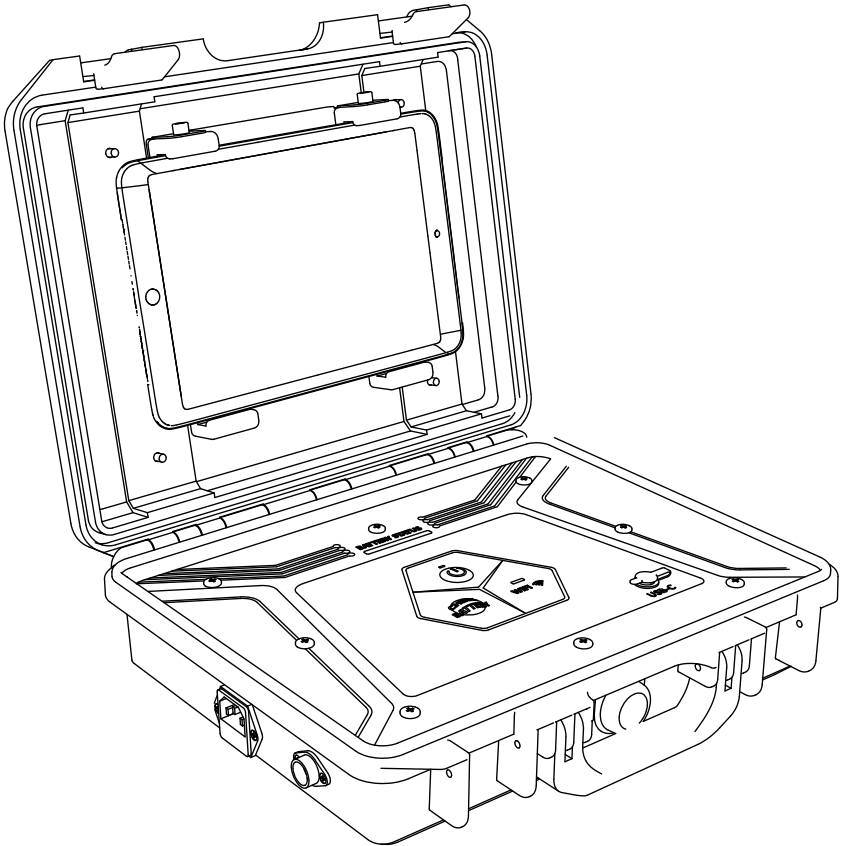

► The following part of this page is the description of Traveler Generation 2

# Control Box (64070081)

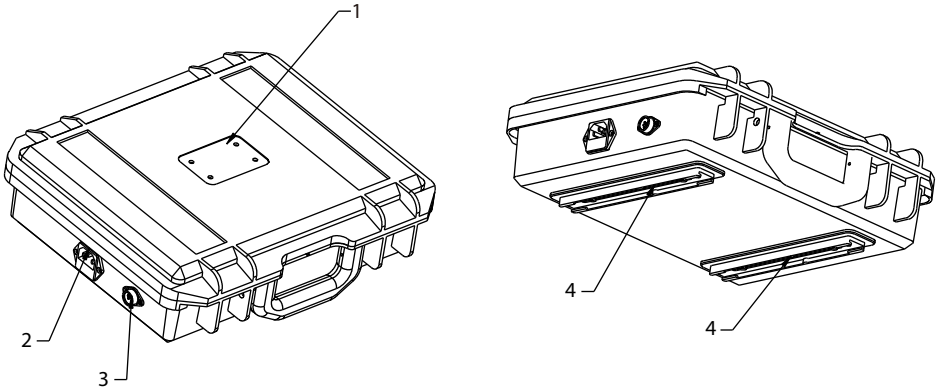

Item	Part Number	Description	Qty.
1	64070090	Decal, control box, T2	1
2	64070020	AC receptacle	1
3	64070029	Aviation connector, control box	1
4	64070034	Rail assembly, control box	2

# Rail Assembly, Control Box (64070034)

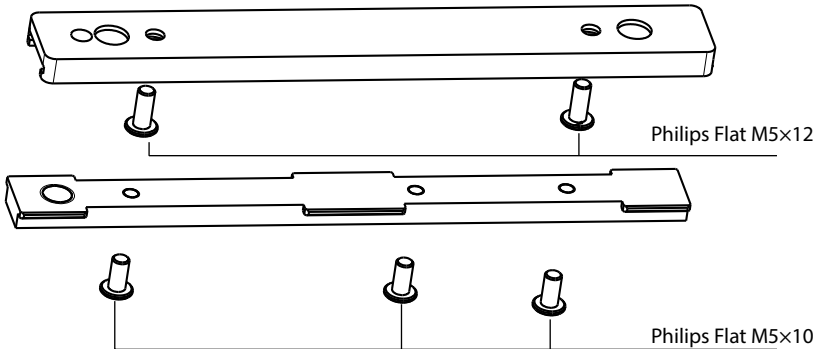

# Control Box (inside)

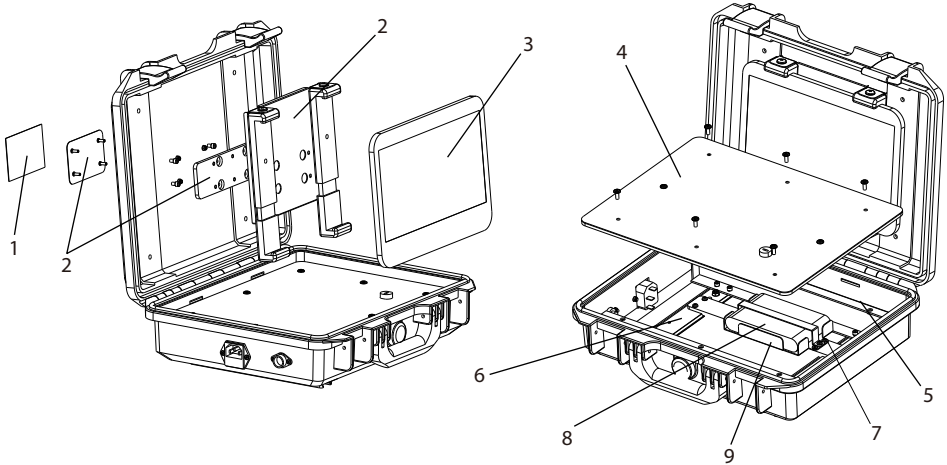

Item	Part Number	Description	Qty.
1	64070090	Decal, control box, T2	1
2	64070033	Tablet holder, T2	1
3	64070032	Spartan iPad with tough case	1
4	64070082	Control Box panel assembly with PCBA, T2	1
5	64070016	Control Box panel stand, T2	2
6	64070018	Vertical bar, control box, T2	2
7	64070019	Horizontal bar, control box, T2	1
8	64050035	Battery, Traveler, 6-cell	1
9	64070017	Battery holder, T2	1

# Tablet Holder, TL2 (64070033)

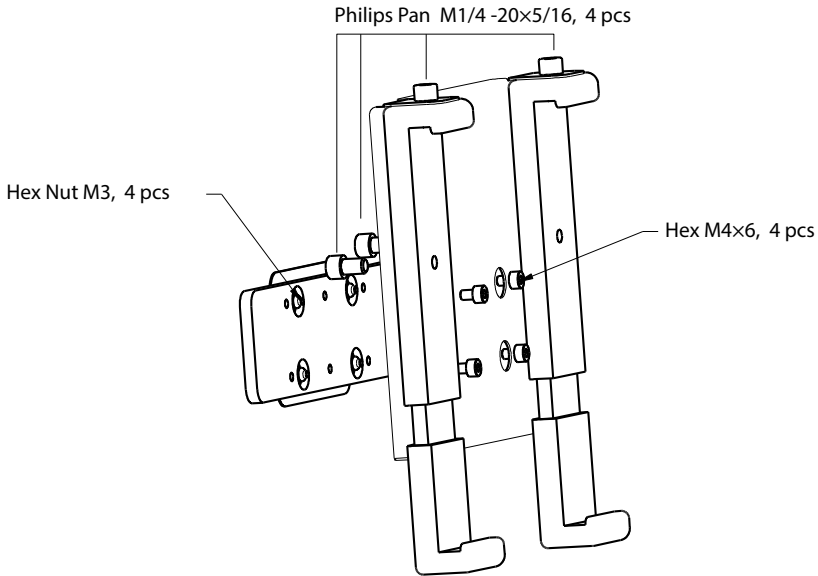

# Battery Holder, TL2 (64070017)

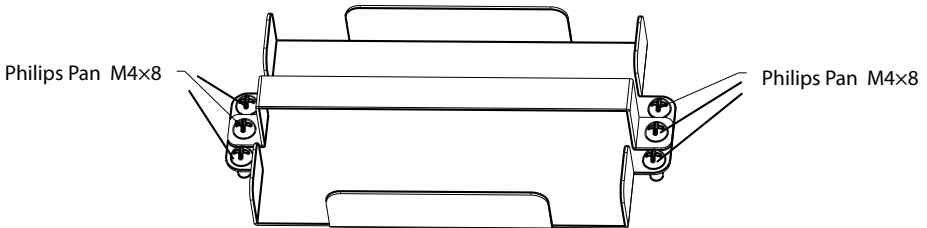

# Control Panel Assembly With PCBA (64070082)

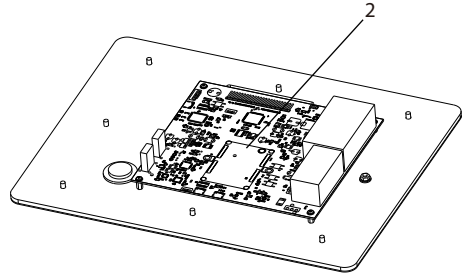
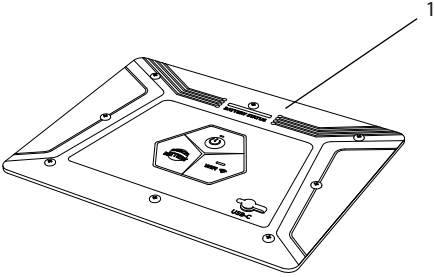

Item	Part Number	Description	Qty.
1	64070103	Control panel assembly, Traveler Gen 2	1
2	64070098	Interface board, Traveler Gen 2	1

# TRAVELER XL HD

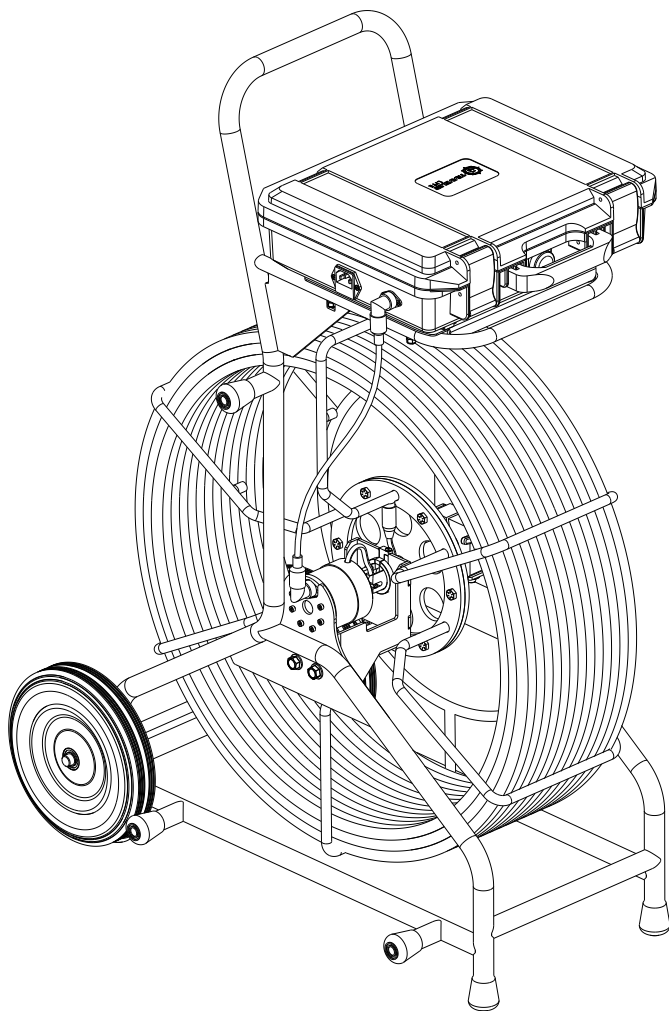

► The following part of this page is the description of TRAVELER XL HD

# Product List

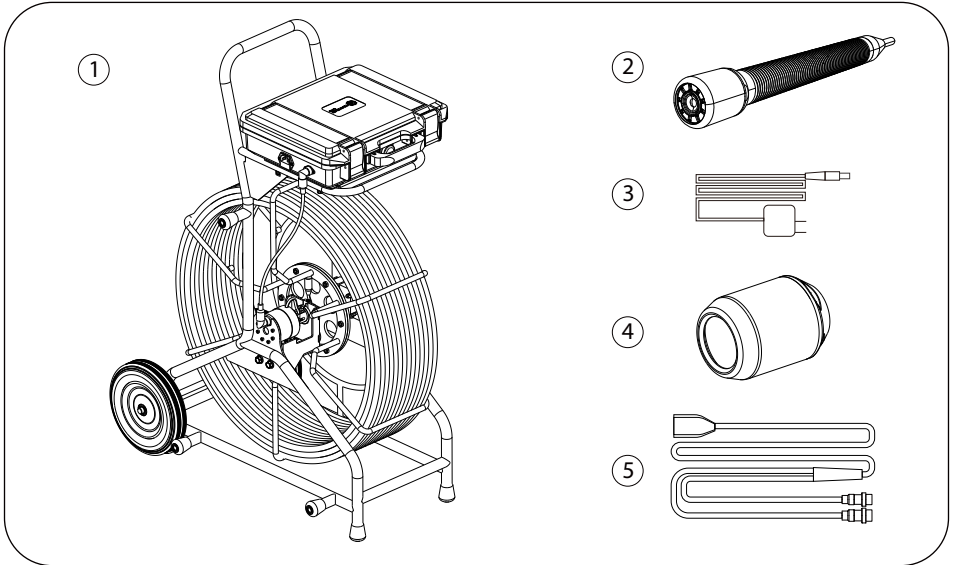

- (1) Traveler XL HD
- (2) Camera head, 40 mm, HD
- (3) AC power cord
- (4) Centering guide
- (5) Testing cord



# Specifications

Item	Description
Battery (In the case)	YBG 18650-2S3P, 10.5 Ah, 7.4 V, 77.7 Wh
Battery Life	Up to 8 hours
Cable Length	61M (200FT)
Camera Light	Built-in White LED lights (9 LEDs)
Camera Angle-of-View	120°
Camera Image	1920 (H) x 1080 (V)
System Operating Temperature	-20°C to + 55°C

## Application:

1. Pipe inspection
2. Waste water system inspection
3. Cable ducting system inspection
4. Ventilation system inspection

## WARNING:

Draining the battery completely will reduce the battery capacity.

# 40mm Camera Head (With Self-leveling)

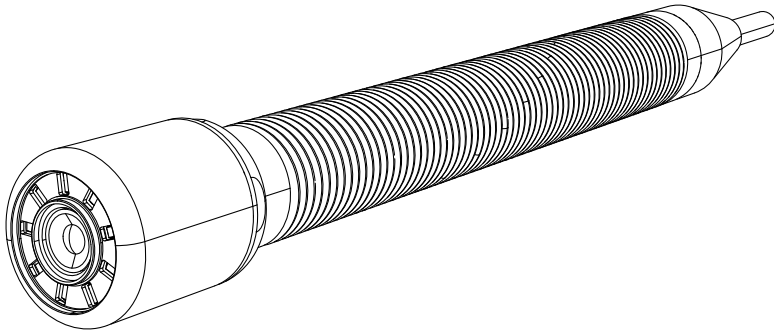

## Working environment:

Temperature: -20°C ~ + 55°C

## Technical specifications:

### (1) Camera module:

- 1) Image sensor: 1/3 inch CMOS
- 2) Effective pixel array: 1920 (H)x1080 (V)
- 3) White Balance: Automatic
- 4) Gain Control: Automatic
- 5) Signal-to-noise ratio: > 52dB (AGC OFF)
- 6) Video output: 1.0Vp-p/75R
- 7) Input voltage: DC12V
- 8) Current consumption: 110mA
- 10) Frame rate: 30FPS/25FPS

### (2) Light Source:

- 1) LED quantity: 9 pcs
- 2) LED brightness: 3000LUX
- 3) LED current: 0~150mA

### External interface:

CAM: Pins 1 to 4 are connected to  
VIDEO, GND, +12V, LED

## WARNING:

Continuously using the camera head with the maximum LED intensity may reduce LED life.

# Parts & Accessories

## Traveler XL HD

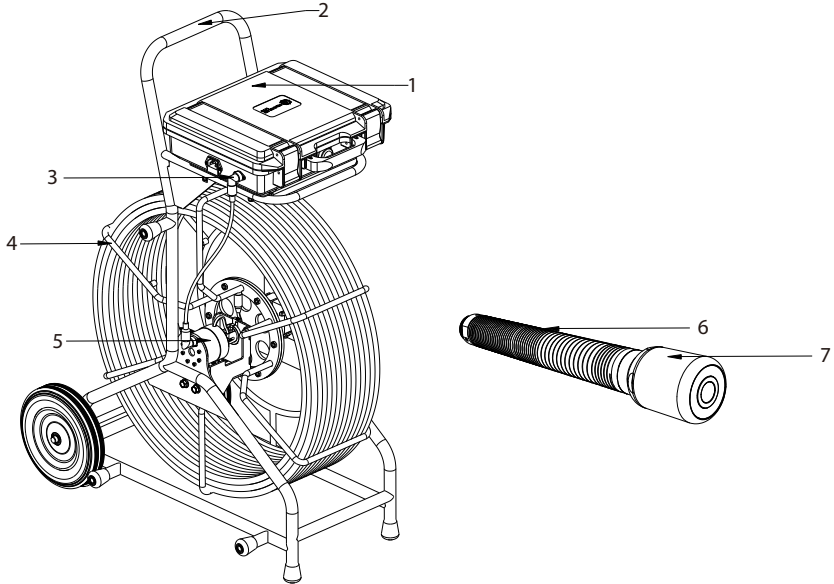

Item	Part Number	Description	Qty.
1	64070081	Control box, T2	1
2	64070104	Body Assembly, TXL HD	1
	64070105	Body Assembly, TXL HD blue	1
	64070106	Body Assembly, TXL HD 300 ft	1
3	64070055	Video cable, TXL HD	1
4	64070075	Cable reel w/ cable, TXL HD	1
	64070076	Cable reel w/ cable, TXL HD blue	1
	64070077	Cable reel w/ cable, TXL HD 300ft	1
5	64070054	Slipring & encoder, TXL HD 200ft	1
	64070091	Slipring & encoder, TXL HD 300ft	1
6	64070093	Flexlink spring	1
	64070094	Flexlink spring, stiff	1
7	64070092	HD Camerahead, 40 mm, TXL HD	1

# Body Frame Assembly, TXL HD

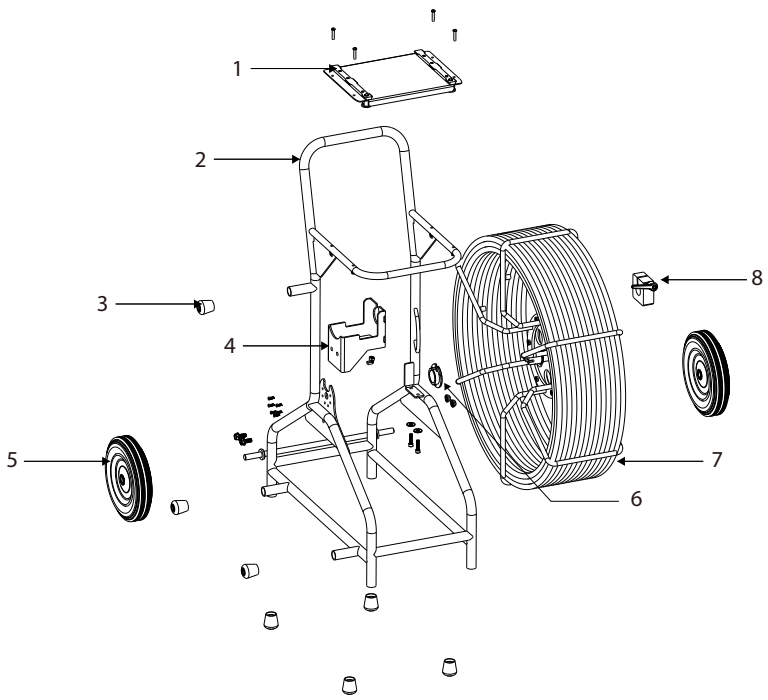

Item	Part Number	Description	Qty.
1	64070057	Control box mounting plate, TXL HD	1
2	64070104	Body Assembly, TXL HD	1
	64070105	Body Assembly, TXL HD blue	1
	64070106	Body Assembly, TXL HD 300 ft	1
3	64070069	Foot, TXL HD	7
4	64070070	Mounting bracket, slipping, TXL HD	1
5	64070072	Wheel, TXL HD	2
6	64070074	Bronze bearing, reel, TXL HD	1
7	64070075	Cable reel w/ cable, TXL HD	1
	64070076	Cable reel w/ cable, Traveler XL blue, TXL HD	1
	64070077	Traveler XL 300 ft, TXL HD	1
8	64070078	Brake, TXL HD	1

# Cable Reel W/ Cable (64070075), TXL HD

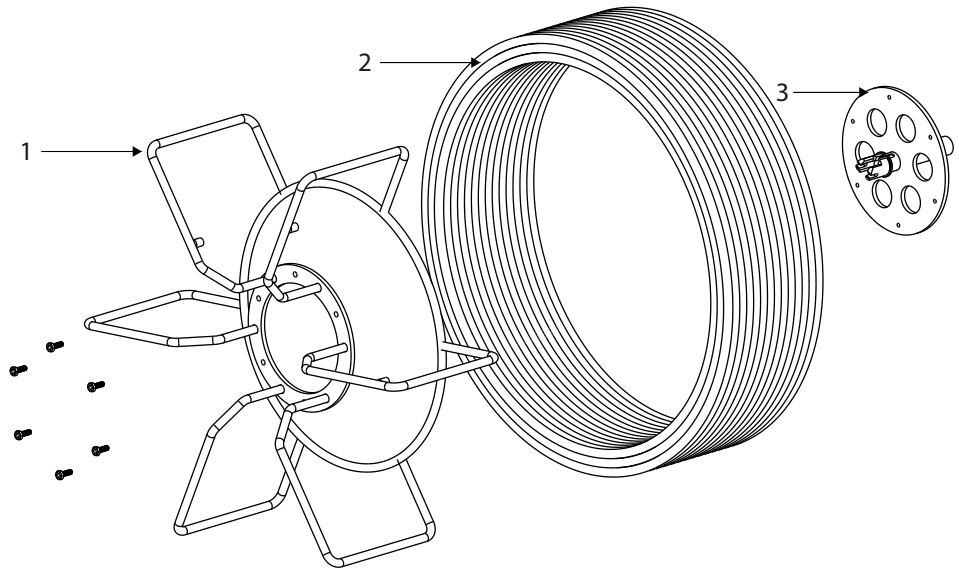

Item	Part Number	Description	Qty.
1	64070079	Cable reel, TXL HD	1
2	64070095	Pushrod, 9mm, 200 ft, TXL HD	1
	64070096	Pushrod, 8mm, 200 ft, TXL HD	1
	64070097	Pushrod, 9mm, 300 ft, TXL HD	1
3	64070080	Hub, cable reel, TXL HD	1



# **SPARTAN TOOL**

FOR TOUGH CUSTOMERS

— SINCE 1943 —

**CONTACT US**  
**Spartan Tool LLC**  
1618 Terminal Road  
Niles, MI 49120  
800.435.3866  
**SpartanTool.com**